

$i = n_1 : n_2 = 1:1$ (Standard und/and HL)

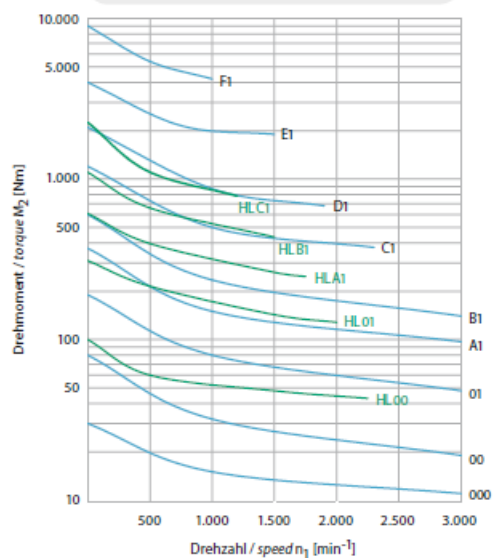

$i = n_1 : n_2 = 2:1$ (Standard und/and HL)

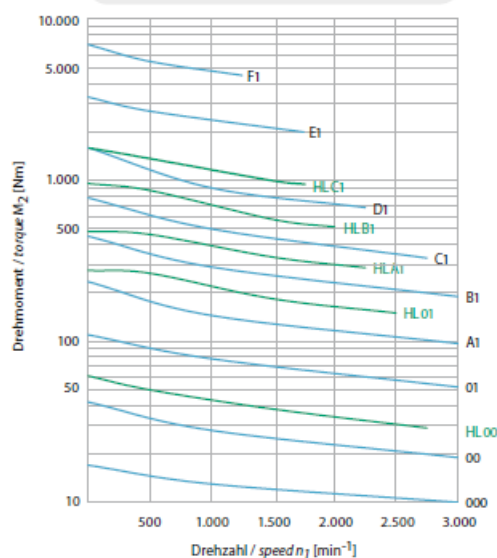

$i = n_1 : n_2 = 5:1$ (Standard)

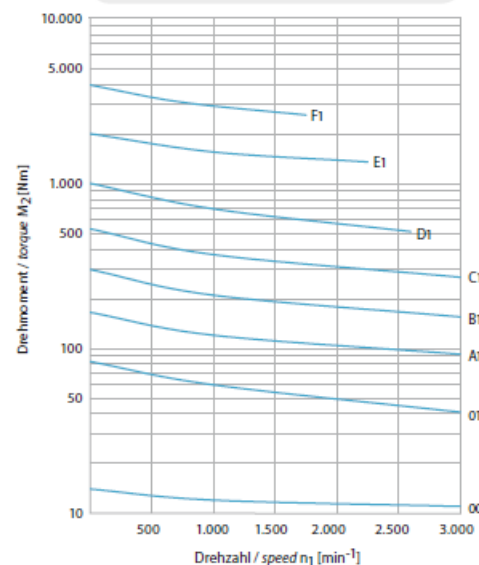

$i = n_1 : n_2 = 6:1$ (Standard)

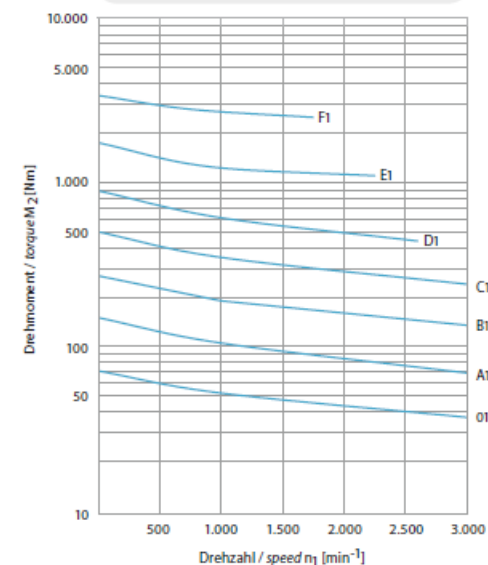

$i = n_1 : n_2 = 3:1$ (Standard und/and HL)

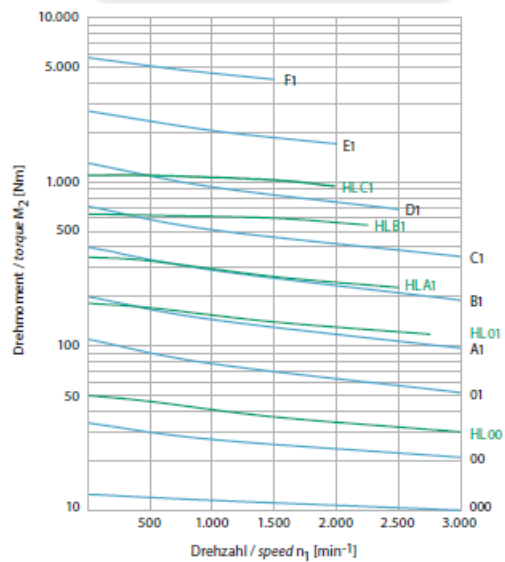

$i = n_1 : n_2 = 4:1$ (Standard)

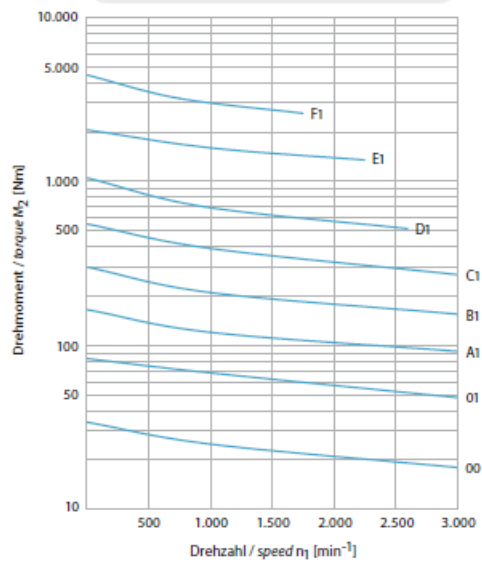

$i = n_1 : n_2 = 1:1,5$ (Standard)

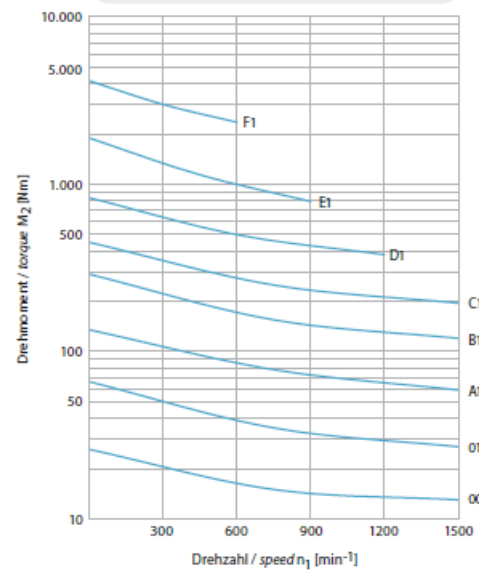

$i = n_1 : n_2 = 1:2$ (Standard)

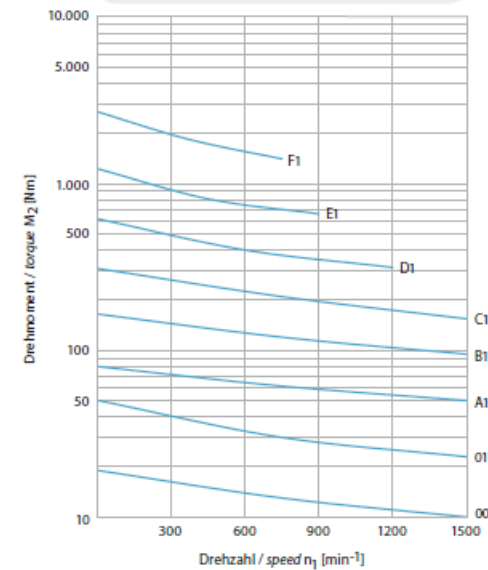

VERSION Flasque d'entrée F



Abb. 18.

dimensions à l'exception des rapports de réduction 1/1,75 et 1/2

Type	a	b	cj7	e	h	k Prof = 1,5 x k	l2	m2	v	w	d2j6	r	clavette DIN 6885/1
F 00	80	110	74	60	60	M6	30	177	117	115	14	M6	5 x 5
F 01	110	145	102	82	82	M8	35	222	152	150	22	M8	6 x 6
F A1	140	175	130	105	105	M10	45	274	184	182	32	M10	10 x 8
F B1	170	215	160	130	130	M12	60	344	224	222	42	M12	12 x 8
F C1	210	260	195	160	160	M16	85	440	270	268	55	M16	16 x 10
F D1	260	330	245	200	200	M16	100	540	340	338	65	M16	18 x 11

1/1,75 et 1/2

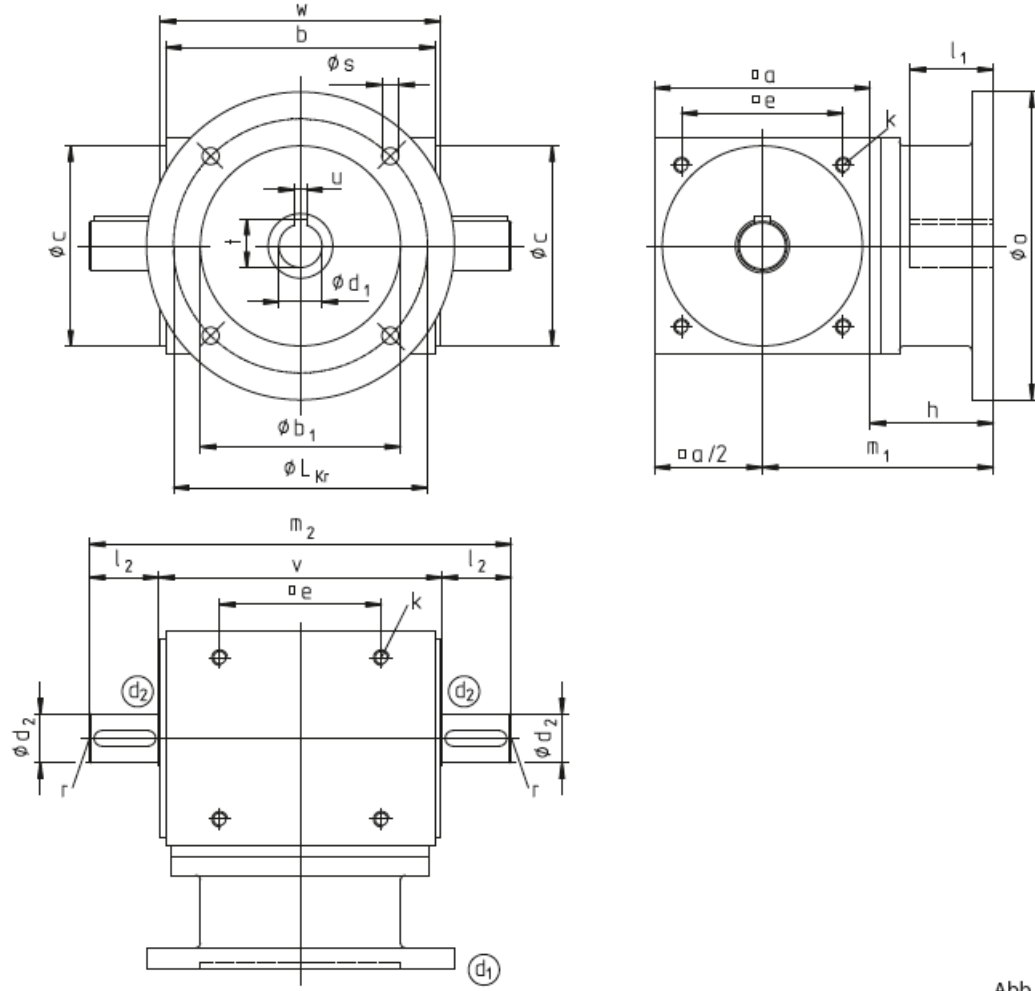
Type	a	b	cj7	e	k Prof = 1,5 x k	l2	m2	v	d2j6	r	clavette DIN 6885/1
F 00	80	110	74	60	M6	25	167	117	12	M5	4 x 4
F 01	110	145	102	82	M8	30	212	152	16	M6	5 x 5
F A1	140	175	130	105	M10	42	268	184	24	M8	8 x 7
F B1	170	215	160	130	M12	50	324	224	28	M8	8 x 7
F C1	210	260	195	160	M16	60	390	270	38	M10	10 x 8
F D1	260	330	245	200	M16	80	500	340	50	M16	14 x 9

dimensions arbre creux d1

Type	l1	m1	t	uj9	d1H7	clavette DIN 6885/1
F 00	30	92	16,3	5	12	5 x 5
F 01	40	128	21,8	6	14	6 x 6
F A1	60	150	31,3	8	22	8 x 7
F B1	60	177	31,3	8	32	8 x 7
F C1	80	197	41,3	10	42	10 x 8
F D1	110	245	51,8	14	55	14 x 9

dimensions arbre creux d1						
Type	l1	t	uj9	d1H7	clavette DIN	
F 01	50	26	8	24	8 x 5	6885/3
F A1	60	27,3	8	24	8 x 7	6885/1
F B1	70	35,3	10	32	10 x 8	6885/1
F C1	85	45,3	12	42	12 x 8	6885/1
F D1	110	59,3	16	55	16 x 10	6885/1

Bride d'entrée DIN 42677									
Taille					o	b1H7	Lkr	s	
105	00				105	70	85	7	
120	00	01			120	80	100	7	
140	00	01			140	95	115	9	
160	00	01	A1	B1	160	110	130	9	
200	01		A1	B1	200	130	165	11	
250	01		A1	B1	C1	250	180	215	13
300				C1	D1	300	230	265	13
350				C1	D1	350	250	300	18
400				D1	400	300	350	18	